

BIHERMA®

PRODUCTS

Franz Wagner & Sohn GmbH

Großer Stein 72
Industriegebiet West
Postbox 6055
D-32646 Lemgo

Fon +49 (0) 52 61 6 80 04

Fax +49 (0) 52 61 6 80 06

www.bitherma.de

info@bitherma.de

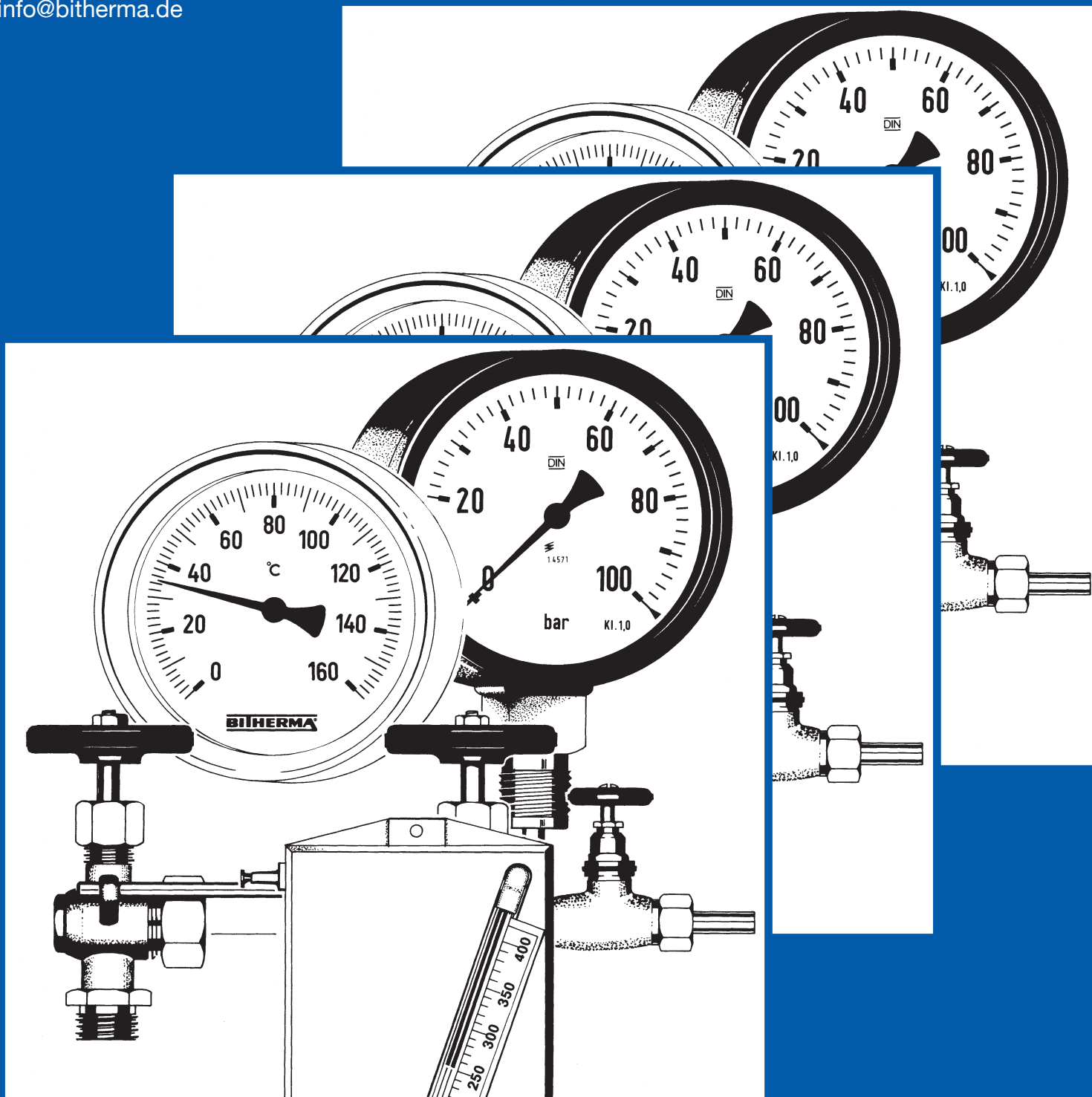

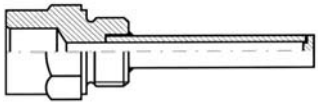
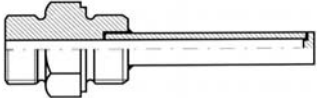
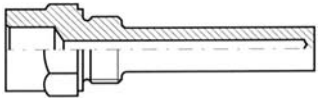
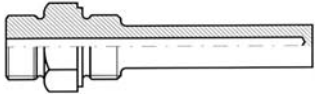
Form 5	<p>G 1/2 female thread / G 1/2 A male thread Brass A/F 27 multipiece soldered PN 25 Stainless steel welded PN 40 Material: brass, 1.4305*, 1.4571 Immersion tube according to needs: Ø 9 / 10 / 12 or 13 mm - NPT 1/2 - G 3/4 - M 18 x 1,5 - M 20 x 1,5 - others</p> 																																												
Form 8	<p>G 1/2 male thread / G 1/2 A male thread Brass A/F 27 multipiece soldered PN 25 Stainless steel welded PN 40 Material: brass, 1.4305*, 1.4571 Immersion tube according to needs: Ø 9 / 10 / 12 or 13 mm - NPT 1/2 - G 3/4 - M 18 x 1,5 - M 20 x 1,5 - others</p> 																																												
Article number:																																													
	<table border="1"> <tr> <td>L1</td> <td>45</td> <td>63</td> <td>80</td> <td>100</td> <td>120</td> <td>160</td> <td>200</td> <td>250</td> <td>300</td> <td>400</td> </tr> <tr> <td>L</td> <td>55</td> <td>73</td> <td>90</td> <td>110</td> <td>130</td> <td>170</td> <td>210</td> <td>260</td> <td>310</td> <td>410</td> </tr> <tr> <td>U1</td> <td>27</td> <td>45</td> <td>62</td> <td>82</td> <td>102</td> <td>142</td> <td>182</td> <td>232</td> <td>282</td> <td>382</td> </tr> <tr> <td>G</td> <td>54</td> <td>72</td> <td>89</td> <td>109</td> <td>129</td> <td>169</td> <td>209</td> <td>259</td> <td>309</td> <td>409</td> </tr> </table>	L1	45	63	80	100	120	160	200	250	300	400	L	55	73	90	110	130	170	210	260	310	410	U1	27	45	62	82	102	142	182	232	282	382	G	54	72	89	109	129	169	209	259	309	409
L1	45	63	80	100	120	160	200	250	300	400																																			
L	55	73	90	110	130	170	210	260	310	410																																			
U1	27	45	62	82	102	142	182	232	282	382																																			
G	54	72	89	109	129	169	209	259	309	409																																			
Material	Form																																												
Brass	5	43.0000	43.0001	43.0002	43.0003	43.0004	43.0005	43.0006	43.0007	43.0008	43.0009																																		
1.4305	5	43.0010	43.0011	43.0012	43.0013	43.0014	43.0015	43.0016	43.0017	43.0018	43.0019																																		
1.4571	5	43.0020	43.0021	43.0022	43.0023	43.0024	43.0025	43.0026	43.0027	43.0028	43.0029																																		
Brass	8	43.0030	43.0031	43.0032	43.0033	43.0034	43.0035	43.0036	43.0037	43.0038	43.0039																																		
1.4305	8	43.0040	43.0041	43.0042	43.0043	43.0044	43.0045	43.0046	43.0047	43.0048	43.0049																																		
1.4571	8	43.0050	43.0051	43.0052	43.0053	43.0054	43.0055	43.0056	43.0057	43.0058	43.0059																																		
Form 6	<p>G 1/2 female thread / G 1/2 A male thread A/F 27 solid machined PN 150 Material: brass, 1.0715, 1.4305, 1.4571 Bore size according to needs: Ø 7 / 9 / 11 oder 13 mm - NPT 1/2 - G 3/4 - M 18 x 1,5 - M 20 x 1,5 - others</p> 																																												
Form 9	<p>G 1/2 male thread / G 1/2 A male thread A/F 27 solid machined PN 150 Material: brass, 1.0715, 1.4305, 1.4571 Bore size according to needs: Ø 7 / 9 / 11 oder 13 mm - NPT 1/2 - G 3/4 - M 18 x 1,5 - M 20 x 1,5 - others</p> 																																												
Article number:																																													
	<table border="1"> <tr> <td>L1</td> <td>45</td> <td>63</td> <td>80</td> <td>100</td> <td>120</td> <td>160</td> <td>200</td> <td>250</td> <td>300</td> <td>400</td> </tr> <tr> <td>L</td> <td>55</td> <td>73</td> <td>90</td> <td>110</td> <td>130</td> <td>170</td> <td>210</td> <td>260</td> <td>310</td> <td>410</td> </tr> <tr> <td>U1</td> <td>27</td> <td>45</td> <td>62</td> <td>82</td> <td>102</td> <td>142</td> <td>182</td> <td>232</td> <td>282</td> <td>382</td> </tr> <tr> <td>G</td> <td>50</td> <td>68</td> <td>85</td> <td>105</td> <td>125</td> <td>165</td> <td>205</td> <td>255</td> <td>305</td> <td>405</td> </tr> </table>	L1	45	63	80	100	120	160	200	250	300	400	L	55	73	90	110	130	170	210	260	310	410	U1	27	45	62	82	102	142	182	232	282	382	G	50	68	85	105	125	165	205	255	305	405
L1	45	63	80	100	120	160	200	250	300	400																																			
L	55	73	90	110	130	170	210	260	310	410																																			
U1	27	45	62	82	102	142	182	232	282	382																																			
G	50	68	85	105	125	165	205	255	305	405																																			
Material	Form																																												
Brass	6	43.0060	43.0061	43.0062	43.0063	43.0064	43.0065	43.0066	43.0067	43.0068	43.0069																																		
1.0715	6	43.0070	43.0071	43.0072	43.0073	43.0074	43.0075	43.0076	43.0077	43.0078	43.0079																																		
1.4305	6	43.0100	43.0101	43.0102	43.0103	43.0104	43.0105	43.0106	43.0107	43.0108	43.0109																																		
1.4571	6	43.0110	43.0111	43.0112	43.0113	43.0114	43.0115	43.0116	43.0117	43.0118	43.0119																																		
Brass	9	43.0140	43.0141	43.0142	43.0143	43.0144	43.0145	43.0146	43.0147	43.0148	43.0149																																		
1.0715	9	43.0150	43.0151	43.0152	43.0153	43.0154	43.0155	43.0156	43.0157	43.0158	43.0159																																		
1.4305	9	43.0180	43.0181	43.0182	43.0183	43.0184	43.0185	43.0186	43.0187	43.0188	43.0189																																		
1.4571	9	43.0190	43.0191	43.0192	43.0193	43.0194	43.0195	43.0196	43.0197	43.0198	43.0199																																		
Thick-walled tube:	<p>- Further materials (please give us your inquiry - OPTIONS</p> <p>Made of 1.4571 for Form 5 und 8 (1.4305 includes stem tube in 1.4571 !): Tube Ø 12 x 2,5 mm wall for instrument probe Ø 6 Tube Ø 14 x 1,5 mm wall for instrument probe Ø 10 Tube Ø 14 x 2,5 mm wall for instrument probe Ø 8</p>																																												
Certificates:	<p>DIN EN 10 204: (replaces DIN 50 049) form 5 / 6 / 8 and 9 available with 2.1 und 2.2</p> <p>Further: 3.1 and 3.2 (form 6 and 9) for 1.4571. For other materials on request !</p> <p>PTFE-coating for high aggressive media on 1.4571 available.</p>																																												

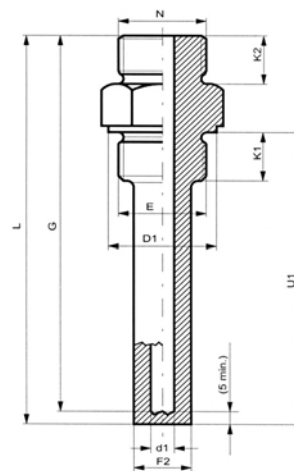
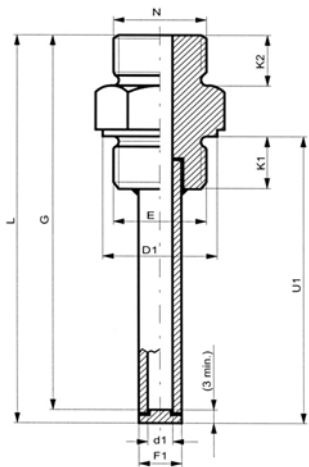
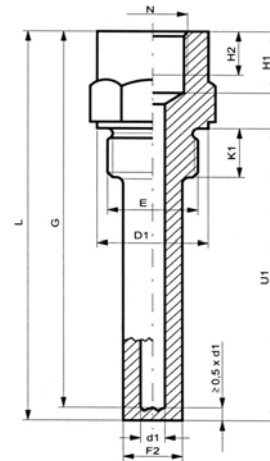
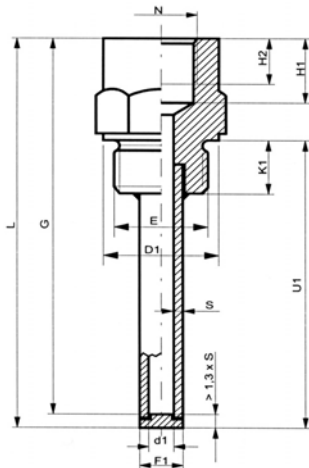

Material	Dimensions in mm																			
	E	N	Ø d1	Ø D1	Ø F1	Ø F2	H1	H2	K1	K2	A/F									
Stainless steel	G1/2A	G 1/2	7	26	12	17	19	15	14	12	27									
			9		14	19														
			11		8	17														
			6,2		10	12														
			8,2		12	19														
			10,2		14	17														
	G3/4A	G 3/4	7	32	12	17	22	17	16	14	32									
			9		14	19														
			11		8	17														
			6,2		10	12														
			8,2		12	19														
			10,2		14	17														
			Brass		G1/2A	G 1/2						7	26	10	17	19	15	14	12	27
												9	32	12	17	22	17	16	14	32
					G3/4A	G 3/4						6,2	26	10	17	19	15	14	12	27
												8,2	32	12	17	22	17	16	14	32

Masses and dimensions are conform to current company standard. Changes to improve our gauges will be made without preannouncement.

Form 4

Female thread M 18 x 1.5

Solid made of material:
1.0035 / 1.0460 / 1.7335 / 1.5415 / 1.4571
Bore hole Ø according to order

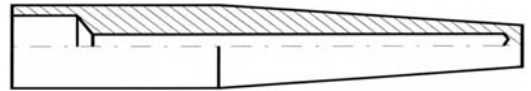

L	110	110	140	170	200	200	260	410
F2	24							
U	65	73	65	133	65	125	125	275
B	Bore hole Ø 7 / Ø 9 / Ø 10 oder Ø 11 mm							

Material

Article number:

1.0035	ST 37	43.0402	43.0403	43.0404	43.0405	43.0406	43.0407	43.0408	43.0409
1.0460	C 22.8	43.0412	43.0413	43.0414	43.0415	43.0416	43.0417	43.0418	43.0419
1.7335	13 CrMo 44	43.0442	43.0443	43.0444	43.0445	43.0446	43.0447	43.0448	43.0449
1.5415	15/16 Mo 3	43.0452	43.0453	43.0454	43.0455	43.0456	43.0457	43.0458	43.0459
1.4571	X6CrNiMoTi17-12-2	43.0432	43.0433	43.0434	43.0435	43.0436	43.0437	43.0438	43.0439

Form 4

Female thread G 1/2

Solid made of material:
1.0035 / 1.0460 / 1.7335 / 1.5415 / 1.4571
Bore hole Ø according to order

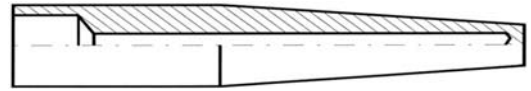

L	110	110	140	170	200	200	260	410
F2	26							
U	65	73	65	133	65	125	125	275
B	Bore hole Ø 7 / Ø 9 / Ø 10 oder Ø 11 mm							

Material

Article number:

1.0035	ST 37	43.0462	43.0463	43.0464	43.0465	43.0466	43.0467	43.0468	43.0469
1.0460	C 22.8	43.0472	43.0473	43.0474	43.0475	43.0476	43.0477	43.0478	43.0479
1.7335	13 CrMo 44	43.0502	43.0503	43.0504	43.0505	43.0506	43.0507	43.0508	43.0509
1.5415	15/16 Mo 3	43.0512	43.0513	43.0514	43.0515	43.0516	43.0517	43.0518	43.0519
1.4571	X6CrNiMoTi17-12-2	43.0492	43.0493	43.0494	43.0495	43.0496	43.0497	43.0498	43.0499

Form 4

Female thread M 14 x 1.5

Solid made of material:
1.0035 / 1.0460 / 1.7335 / 1.5415 / 1.4571
Bore hole Ø 3.5 mm

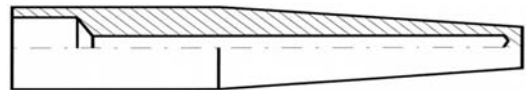

L	110	110	140	170	200	200	260
F2	18						
U	65	73	65	133	65	125	125
B	Bore hole Ø 3.5 mm						

Material

Article number:

1.0035	ST 37	43.0522	43.0523	43.0524	43.0525	43.0526	43.0527	43.0528
1.0460	C 22.8	43.0532	43.0533	43.0534	43.0535	43.0536	43.0537	43.0538
1.7335	13 CrMo 44	43.0682	43.0683	43.0684	43.0685	43.0686	43.0687	43.0688
1.5415	15/16 Mo 3	43.0692	43.0693	43.0694	43.0695	43.0696	43.0697	43.0698
1.4571	X6CrNiMoTi17-12-2	43.0552	43.0553	43.0554	43.0555	43.0556	43.0557	43.0558

Accessories:

Extension neck L = 165 made of stainless steel
Plug screws
Suitable welding sleeves: bore hole Ø 18 / 24 or 26 mm. L = according to order.

Certificates:

DIN EN 10 204 2.1 and 2.2 available.

DIN EN 10 204 3.1 for 1.0460 / 1.7335 / 1.5415 and 1.4571.

For other materials with certificate 3.1 or TÜV approval 3.2 on request !

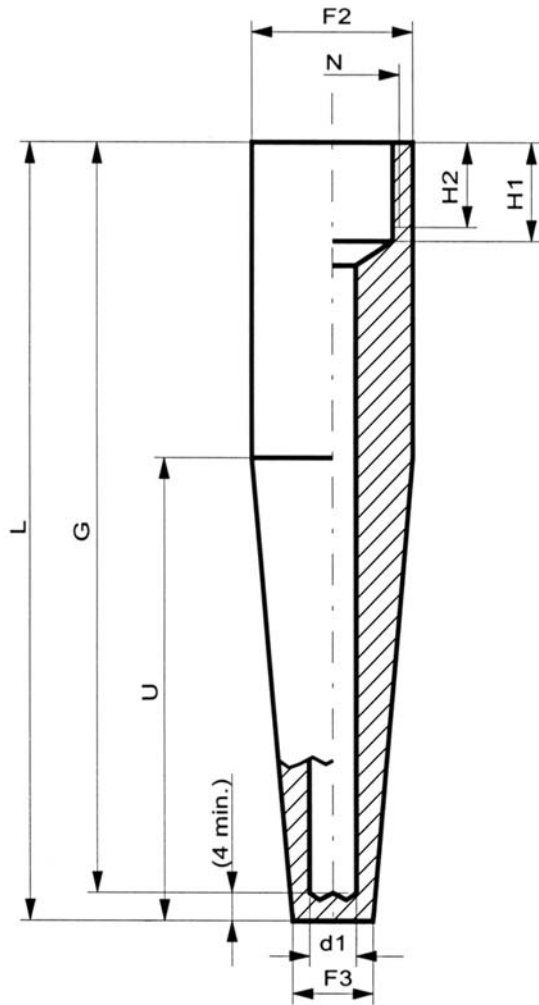

Extension neck L = 165 mm

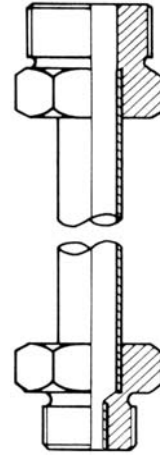

Welding sleeves

with female thread

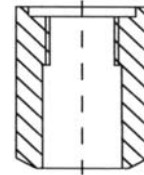

without thread for form 4

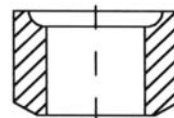

without thread for form 4
with weld-on radius chamfer

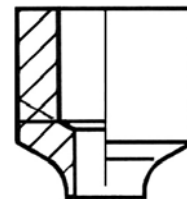

Dim. in mm	
L	U
110	65
	73
140	65
170	133
200	65
	125
260	125
410*	275

Dimensions in mm					
N	Ø d1	Ø F2	Ø F3	H1	H2
M 14 x 1.5	3.5	18	9	16	13
M 18 x 1.5	7	24	12.5		
G 1/2	9	26	15	19	15
	11		17		
G 3/4	11	32	17	22	17

* not available for bore hole Ø 3.5

Masses and dimensions are conform to current company standard. Changes to improve our gauges will be made without preannouncement.

Flange DIN 2527
Form C / D / E
with raised face

Is used in connection with all common screw-in and
weld-in thermowells.

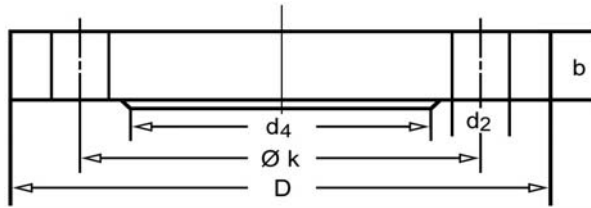

E.g.:

ND 16

NW DN	Flange			Screws		
	D	b	k	Quantity	Thread	d2
15	95	14	65	4	M 12	14
20	105	16	75	4	M 12	14
25	115	16	85	4	M 12	14
32	140	16	100	4	M 16	18
40	150	16	110	4	M 16	18
50	165	18	125	4	M 16	18

Clamp-flange
(TRI-CLAMP)
ISO 2852

Can be attached to all temperature measuring instruments with stainless steel stem.

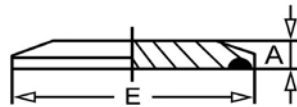

Size	DN	A	E
1"	25	6	50,5
1 1/2"	40	6	50,5
2"	50	6	64
3"	65	7	91

Round slotted nut
DIN 11 851 and
conical coupling

Can be attached to all temperature measuring instruments with stainless steel stem.

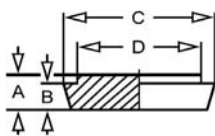

DN	A	B	C	D
15	9	6	28	24
20	11	8	36	30
25	13	10	44	35
32	13	10	50	41
40	13	10	56	48
50	14	11	68	61

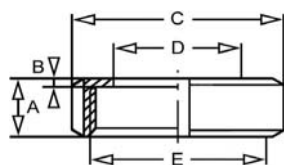

DN	A	B	C	D	Size
15	18	3	44	25	1"
20	20	3	54	31	
25	21	3	63	36	
32	21	3	70	42	1 1/2"
40	21	3	78	49	
50	22	3	92	62	2"

Certificates:

DIN EN 10 204 2.1 and 2.2 available. 3.1 and 3.2 on request.