

case:	stainless steel with solid baffle wall and blow-out back - contacts - surface mounting lugs
bezel:	bayonet, stainless steel - panel mounting flange
dial:	aluminium, white figures and graduation black with pointer stop pin (diam. 63) - red mark-pointer
pointer:	aluminium, black
window:	laminated safety glass - max. drag-pointer
movement:	stainless steel
pressure element:	stainless steel 1.4571
connection:	stainless steel 1.4571, vertical or rear entry G1/4, SW 14 (diam. 63) G1/2, SW 22 (diam. 100, 160 – only vertical entry) (EN 837-1/7.3)
measuring range (EN 837-1/5):	0/1 bar ... 0/1000bar (diam. 63) 0/0.6 bar ... 0/1000bar (diam. 100) 0/0.6 bar ... 0/1600bar (diam. 160) or equivalent other units of pressure or vacuum
accuracy (EN 837-1/6):	class 1.6 (diam. 63) class 1.0 (diam. 100, 160)
working pressure:	steady: full scale value fluctuating: 0.9 x full scale value short time: 1.3 x full scale value full scale value (diam. 63)
operating temp.:	ambient: TMIN -40°C, TMAX +60°C, medium: TMAX +200°C - OPTIONS

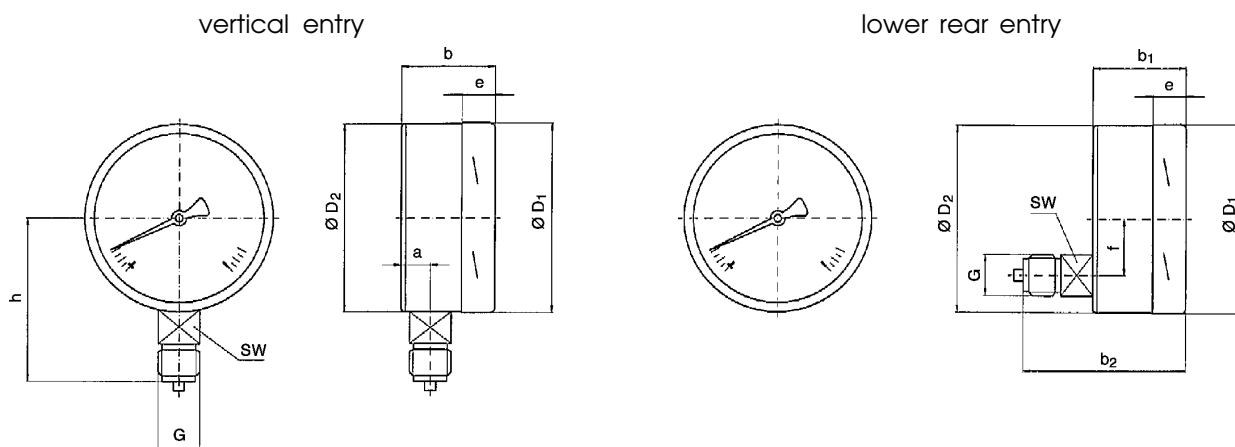

dimensions

standard versions



diam.	dimensions (mm)											net weight (kg)
	a	b	b1	b2	D1	D2	e	f	G	h ± 1	SW	
63	17.5	42	42	61	63	63	14.5	18.5	G 1/4	53	14	0.20
100	24	57.5	57.5	93	101	100	17.5	30	G 1/2	87	22	0.65
160	24	58 ¹⁾	-	-	161	160	17.5	-	G 1/2	118	22	1.30 ¹⁾

connection acc. to EN 837-1/7.3

¹⁾ measuring range 1600 bar 75.5 mm respectively 1.5 kg

type		232.30				
diam.		63		100		160
version						
-1200 - 0	mbar	x	x	x	x	x
-1 - 0	bar	9600	x	9700	x	x
-1 + 0.6		x	x	9701	x	x
-1 + 1.5		x	x	9702	x	x
-1 + 3		9644	x	9703	x	x
-1 + 5		x	x	9704	x	x
-1 + 9		x	x	9705	x	x
-1 + 15		9599	x	9706	x	x
0 - 0.6		-	-	9722	x	x
0 - 1		9645	x	9707	x	9727
0 - 1.6		9601	9611	9708	x	9728
0 - 2.5		9602	9612	9709	x	9729
0 - 4		9603	9613	9710	x	9730
0 - 6		9604	9614	9711	x	9731
0 - 10		9605	9615	9712	x	9732
0 - 16		9606	9616	9713	x	9733
0 - 25	9607	9617	9714	x	9734	
0 - 40	9608	9618	9715	x	9735	
0 - 60	9609	9619	9716	x	9736	
0 - 100	9610	x	9717	x	9737	
0 - 160	9597	x	9718	x	9738	
0 - 250	9598	x	9719	x	x	
0 - 400	x	x	9720	x	x	
0 - 600	9646	x	9721	x	x	
0 - 1000	x	x	x	x	x	
0 - 1600	-	-	x	x	x	

Dimensions and technical data according to technical standard of today. Changes which make our products better will be made without proclaiming.