



- Case:** Steel zined varnished
 - Bayonet-fitted stainless steel IP 54 (diam. 63-160)
- Bezel:** Steel chromed
- Dial:** Aluminium, white varnished
 lettering and graduation black
 - Red mark
 - Imprint
 - Double scale °C/°F
- Pointer:** Aluminium, black
 adjustable at end of stem
 - Silicone damped
- Window:** Instrument glass
 - Safety glass (diam. 63-160)
 - Max. drag pointer (diam. 63-160)
 - Max./min. drag pointer (diam. 63-160)
 - Red mark pointer (diam. 63-160)
- Distance ring:** Internal, Aluminium
- Stem:** G 1/2 B brass detachable with fixing screw
 L = 28 / 45 / 50 / 63 / 100 mm solid A/F 21
 other lengths multi-part soldered A/F 21, tube Ø 12
 - Further connections see overleaf resp. 001
- Connection:** Bottom entry
 - sideways
- Measuring range:** 0-120°C
 - Resp. opposite
- Accuracy class:** 1.6
 - Accuracy class 1.0
 Then the article number changes
 from 2XXX into 3XXX !
 - Works test certificate
- OPTIONS

		Article number:				
		50	63	80	100	160
Stem	Diam. 28 mm	2250	2260	2280	2300	2360
Stem	45 mm	2251	2261	2281	2301	2361
Stem	50 mm	2252	2262	2282	2302	2362
Stem	63 mm	2253	2263	2283	2303	2363
Stem	80 mm	2254	2264	2284	2304	2364
Stem	100 mm	2255	2265	2285	2305	2365
Stem	120 mm	2256	2266	2286	2306	2366
Stem	160 mm	2257	2267	2287	2307	2367
Stem	200 mm	2258	2268	2288	2308	2368
Stem	250 mm	2259	2269	2289	2309	2369

Meas. range	Graduation
-40+40°C	1.0
-30+50°C	
-20+60°C	
-20+40°C	
-15+45°C	
-10+60°C	
-10+50°C	
0+50°C	
0+60°C	
0+80°C	
0+100°C	2.0
0+120°C	
0+160°C	
0+200°C	
0+250°C	5.0
0+300°C	
0+400°C	10.0
0+500°C *	
0+600°C *	

Other lengths are available !

Stem 28 mm only 0-120°C available !
 Measuring span 50 and 60°C shortest stem = 100 mm !

*Stem stainless steel needed !

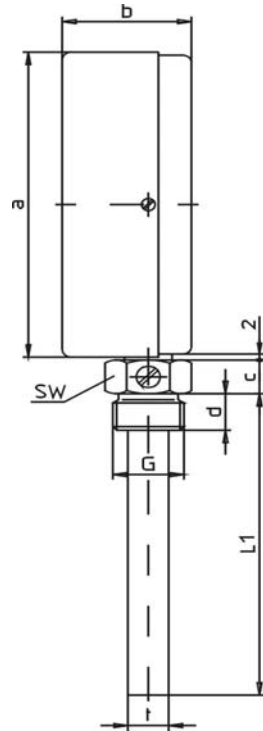

Type	a	b	c	d	SW	G	t
2250	50	35	11	12	21	1/2 B	12
2260	63	36	11	12	21	1/2 B	12
2280	80	36	11	12	21	1/2 B	12
2300	100	38	11	12	21	1/2 B	12
2360	160	38	11	12	21	1/2 B	12

0	1	2	3	4	5	6
Sep. pocket with fixing screw	Fixed connection male thread	Union nut female thread	Union nut with double nipple	Union nut with additional thermowell acc. to DIN 16179 form CD or DIN 43772 form 8	Turnable male thread	Movable clamp connection

Masses and dimensions are conform to current company standard. Changes to improve our gauges will be made without preannouncement.