



Case:	Steel zined, black varnished - Diam. 100 stainless steel 1.4301
Bezel:	Steel nickel-plated - Brass chromed (diam. 80-160) - Stainless steel 1.4301
Dial:	Aluminium, white varnished lettering and graduation black - Red mark - Imprint - Double scale °C/°F
Pointer:	Aluminium, black adjustable at end of stem - Silicone damped
Window:	Instrument glass - Safety glass - Max. drag pointer - Max./min. drag pointer - Red mark pointer
Distance ring:	Internal up to 120°C cellular rubber from 160°C on aluminium, diam. 160 ALU only
Stem:	Brass, Ø 9 mm - Stainless steel 1.4571
Mounting method:	With back flange heavy version, flattened for surface mounting on air duct - Diam. 100 stainless steel round - With front flange brass chromed, for panel mounting
Connection:	Backwards
Measuring range:	0-120°C - Resp. opposite
Accuracy class:	2 - Accuracy class 1.0  - Works test certificate  - OPTIONS

Meas. range	Graduation
-40+40°C	1.0
-30+50°C	
-20+60°C	
-20+40°C	
-15+45°C	
-10+60°C	
-10+50°C	
0+40°C	
0+50°C	
0+60°C	
0+80°C	2.0
0+100°C	
0+120°C	
0+160°C	
0+200°C	
0+250°C	5.0
0+300°C	
0+400°C	10.0
0+500°C *	
0+600°C *	

	Diam.	63	80	100	160
Stem 50 mm		1461	1481	1501	1561
Stem 100 mm		1462	1482	1502	1562
Stem 150 mm		1463	1483	1503	1563
Stem 200 mm		1464	1484	1504	1564
Stem 250 mm		1465	1485	1505	1565

Other lengths are available !

\*Stem stainless steel needed !

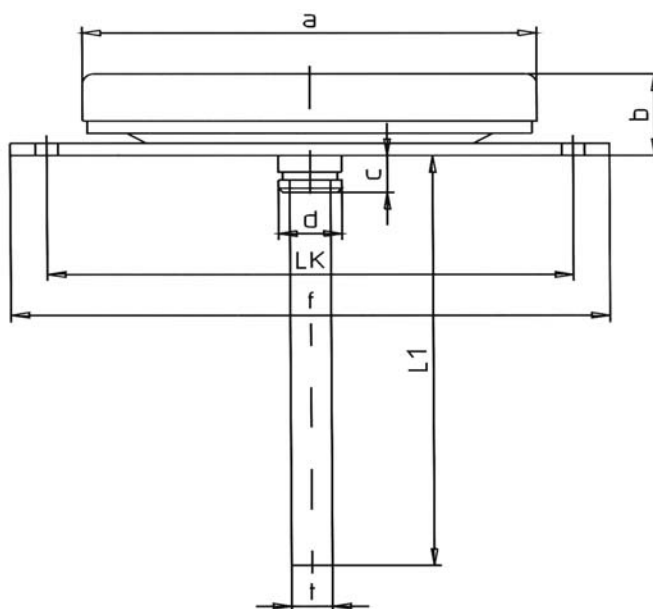

Type	a	b	c	d	f	LK	t
1460	63	17	7	14	85	76	9
1480	80	21	7	14	110	95	9
1500	100	22	7	14	132	116	9
1560	160	23	7	14	190	182	9

Masses and dimensions are conform to current company standard. Changes to improve our gauges will be made without preannouncement.