

Case:	Steel zinced - Stainless steel AISI 304
Bezel:	Steel nickel plated - Stainless steel AISI 304
Protection class:	IP 43
Dial:	Aluminium, white varnished lettering and graduation black - Red mark - Imprint - Double scale °C/°F
Pointer:	Aluminium, black adjustable at end of stem - Silicone damped
Window:	Instrument glass - Perspex window - Laminated safety glass - Max. drag pointer - Max./Min. drag pointer - Red mark pointer
Stem:	Brass Ø 9 mm - Stainless steel of AISI 316 Ti
Mounting method:	Flange steel zinced Ø 40 mm with fixing screw movable on stem diam. 160 mm, flange Ø 80 mm steel zinced - Thread G ½ B brass with fixing screw - Flange Ø 80 steel zinced - Flange Ø 80 stainless steel
Connection:	Backwards
Measuring range:	0-120°C - Resp. opposite
Accuracy class:	2 - Accuracy class 1 - Works test certificate - OPTIONS

Measuring-range	Graduation
-40 +40°C	1°
-30 +50°C	
-20 +60°C	
-20 +40°C	
-15 +45°C	
-10 +60°C	
-10 +50°C	
0 -40°C	
0 -50°C	
0 -60°C	
0 -80°C	2°
0 -100°C	
0 -120°C	
0 -160°C	
0 -200°C	
0 -250°C	5°
0 -300°C	
0 -400°C	10°
1) 0 -500°C	
1) 0 -600°C	

		Article number:			
Diam.:	mm	63	80	100	160
Stem	50 mm	1261	1281	1301	1361
Stem	100 mm	1262	1282	1302	1362
Stem	150 mm	1263	1283	1303	1363
Stem	200 mm	1264	1284	1304	1364
Stem	250 mm	1265	1285	1305	1365

Other lengths are available!

1) stem stainless steel needed

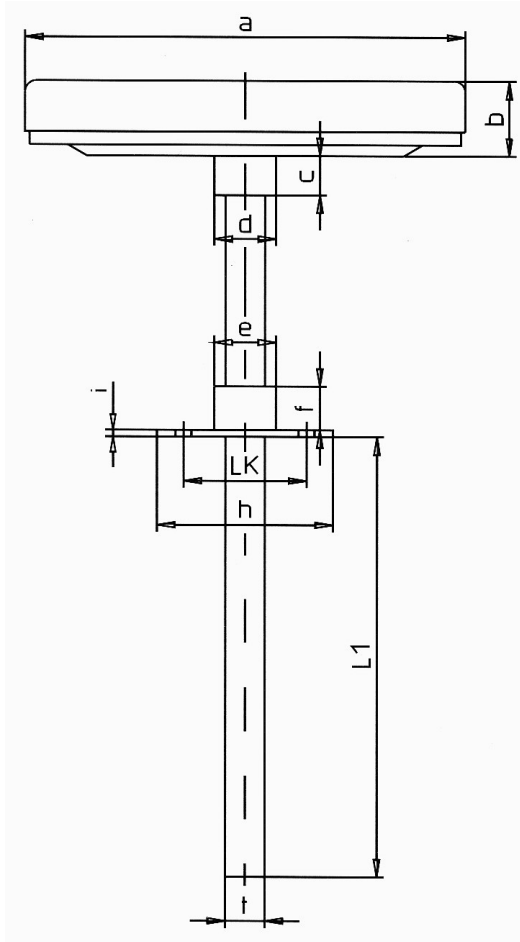

Type	a	b	c	d	e	f	LK	h	i	t
1260	63	13	9	14	14	10	28	40	1,5	9
1280	80	13	9	14	14	10	28	40	1,5	9
1300	100	15	9	14	14	10	28	40	1,5	9
1360	160	19	9	14	14	10	54	80	2,0	9

Dimensions and technical data are conform to current company standard.
 Changes to improve our instruments will be made without preannouncement.