



Case:	Steel zinced
Bezel:	Steel nickel plated
Protection class:	IP 34
Dial:	Aluminium, white varnished lettering and graduation black - Red mark - Imprint - Double scale °C/°F
Pointer:	Aluminium, black adjustable at end of stem - Silicone damped
Window:	Instrument glass - Perspex window - Laminated safety glass - Max. drag pointer - Max./Min. drag pointer - Red mark pointer
Stem:	Brass Ø 9 mm - Stainless steel of AISI 316 Ti
Mounting method:	With back flange lightweight version, round for surface mounting on air duct
Connection:	Backwards
Measuring range:	0-120°C - Resp. opposite
Accuracy class:	2 - Accuracy class 1 - Works test certificate - OPTIONS

		Article number:		
Diam.:	mm	63	80	100
Stem	50 mm	1661	1681	1701
Stem	100 mm	1662	1682	1702
Stem	150 mm	1663	1683	1703
Stem	200 mm	1664	1684	1704
Stem	250 mm	1665	1685	1705

Measuring-range	Graduation
-40 +40°C	1°
-30 +50°C	
-20 +60°C	
-20 +40°C	
-15 +45°C	
-10 +60°C	
-10 +50°C	
0 -40°C	
0 -50°C	
0 -60°C	
0 -80°C	2°
0 -100°C	
0 -120°C	
0 -160°C	
0 -200°C	
0 -250°C	5°
0 -300°C	
0 -400°C	10°
1) 0 -500°C	
1) 0 -600°C	

1) stem stainless steel needed

Other lengths are available!

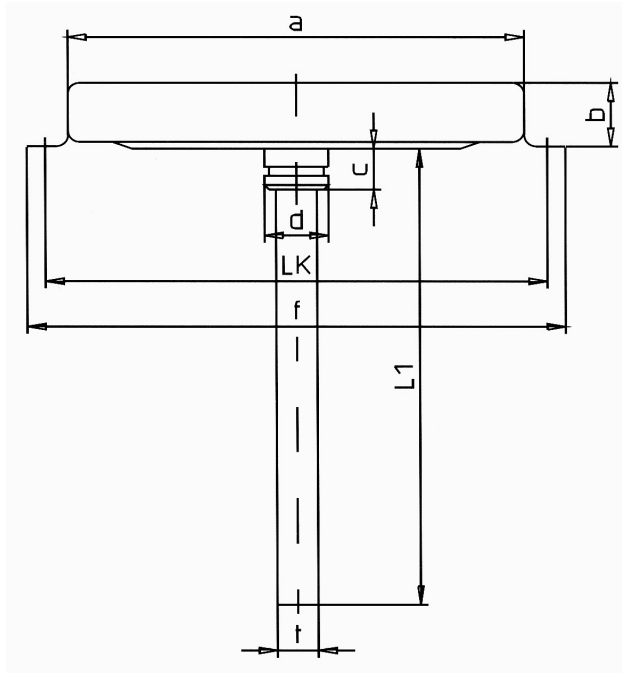

Type	a	b	c	d	f	LK	t
1660	63	14	9	14	82	74	9
1680	80	14	9	14	102	91	9
1700	100	14	9	14	118	110	9

Dimensions and technical data are conform to current company standard.
 Changes to improve our instruments will be made without preannouncement.