

Case:	Steel zined - Stainless steel AISI 304
Bezel:	Steel nickel plated - Stainless steel AISI 304
Protection class:	IP 34
Dial:	Aluminium, white varnished from 500°C blank aluminium lettering and graduation black - Red mark - Imprint - Double scale °C/°F
Pointer:	Aluminium, black adjustable at end of stem
Window:	Instrument glass - Max. drag pointer (diam. 63-100) - Max./Min. drag pointer (diam. 63-100)
Stem:	L = 200 x Ø 8 mm made of stainless steel AISI 316 Ti - Other lengths
Mounting method:	conical thread A/F 13 made of brass with fixing screw - Thread G ½ B brass with fixing screw
Connection:	Backwards
Accuracy class:	2 - Accuracy class 1 - Works test certificate - OPTIONS

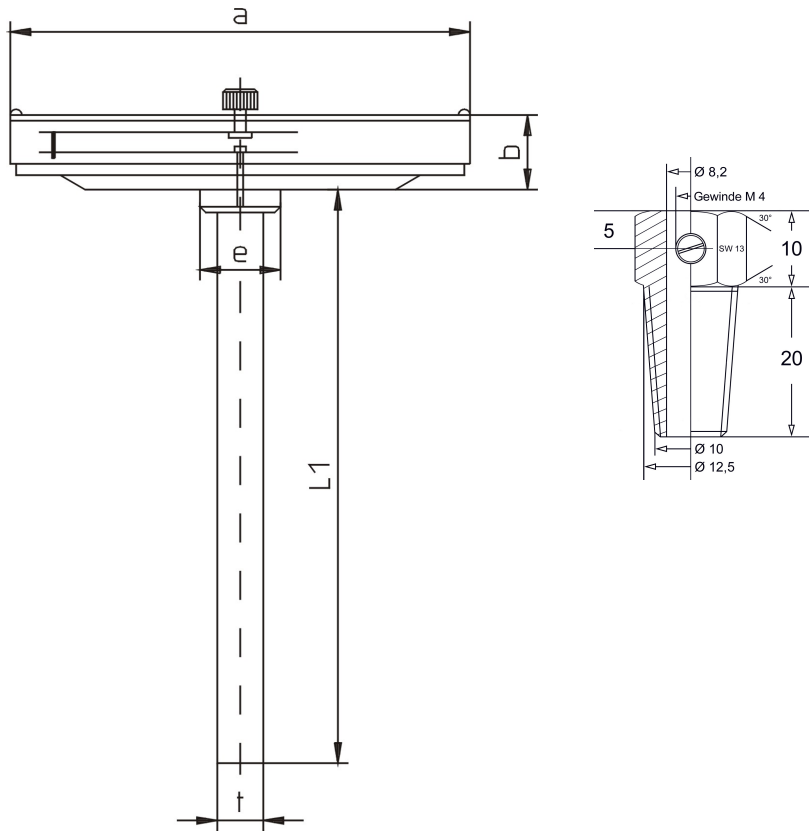

Picture shows an instrument with max./min. drag pointer

Measuring range:	Article number:			
Diam.: mm	50	63	80	100
0-250°C	1851	1861	1881	1901
0-300°C	1852	1862	1882	1902
0-400°C	1853	1863	1883	1903
0-500°C	1854	1864	1884	1904



Type	a	b	e	t
1850	50	12	14	8
1860	63	13	14	8
1880	80	13	14	8
1900	100	15	14	8

Dimensions and technical data are conform to current company standard.
 Changes to improve our instruments will be made without preannouncement.